

# Admission Book 2025

Office of International Students  
Beijing Institute of Technology





**Beijing**, the capital of China, is a national central city and megacity. It is endowed with the functions of the country's political, cultural and international exchange and scientific and technological innovation center.

Situated in northeastern Zhejiang Province, central part of the Yangtze Delta, **Jiaxing** holds an advantaged geographic location. The city is approximately 100 kilometers away from both Shanghai and Hangzhou, with a journey time of around 30 minutes by high-speed rail.

**Zhuhai**, located in the southern part of Guangdong Province, is China's second largest port city after Shenzhen. It is the only city in the Chinese mainland with both a bridge to Hong Kong and roads to Macao. Both Guangzhou and Shenzhen are approximately 120 kilometers from Zhuhai, with a journey time of around 55 minutes to Guangzhou by high-speed rail and 2 hours to Shenzhen by coach.

# BIT

BEIJING  
INSTITUTE  
OF TECHNOLOGY

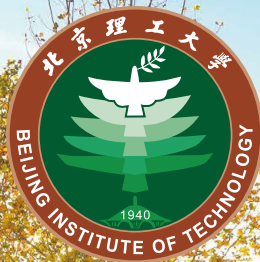

# Admission Book 2025

德以明理 学以精工



## CONTACT US



**GAO Shan**

Director

Phone: +86-10-68918316

Email: gaoshanbit@163.com



**SHEN Jiapei**

Manager of Admission Section

Phone: +86-10-68918272

Email: jiapeishen@bit.edu.cn



**YANG Yanan**

Associate Director

Phone: +86-10-68918757

Email: yyn@bit.edu.cn



**LIU Weiguang**

Associate Director

Phone: +86-10-68912934

Email: liuweiguang@bit.edu.cn

## Admission Section

### *Undergraduate Programs*

Phone: 86-10-68918272

Email: undergraduate@bit.edu.cn

### *Graduate Programs*

Phone: 86-10-68910992

Email: master\_phd@bit.edu.cn

### *Chinese Language Programs*

Phone: 86-10-68912161

Email: studychinese@bit.edu.cn

### *Exchange Programs*

Phone: 86-10-68910992

Email: incoming\_exchange@bit.edu.cn



# BIT HISTORY

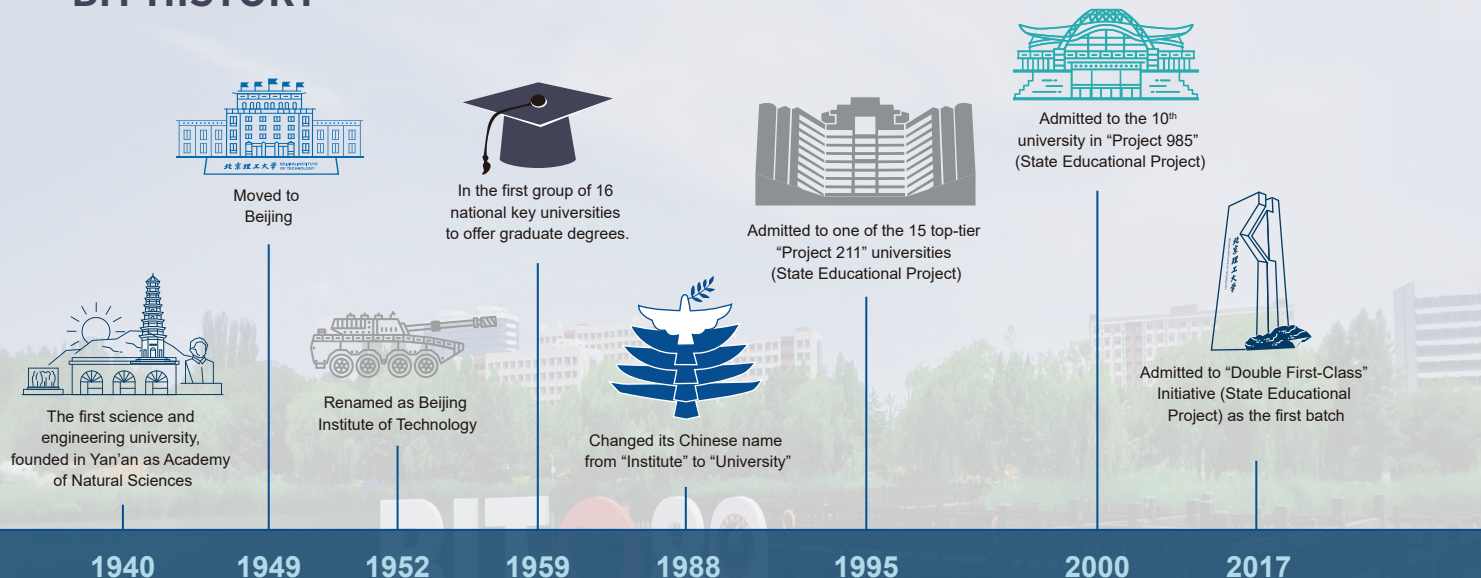

1940: The first science and engineering university, founded in Yan'an as Academy of Natural Sciences

1949: Moved to Beijing

1952: Renamed as Beijing Institute of Technology

1959: In the first group of 16 national key universities to offer graduate degrees

1988: Changed its Chinese name from "Institute" to "University"

1995: Admitted to one of the 15 top-tier "Project 211" universities (State Educational Project)

2000: Admitted to the 10<sup>th</sup> university in "Project 985" (State Educational Project)

2017: Admitted to "Double First-Class" Initiative (State Educational Project) as the first batch

# CONTENTS

- 01** BIT Rankings
- 02** BIT Figures
- 03** Schools
- 04** Undergraduate Programs in Chinese
- 05** Undergraduate Programs in English
- 07** Master's Programs in Chinese and English
- 08** Ph.D. Programs in Chinese & English
- 09** Non-degree Programs
- 10** How to Apply?
- 11** What Scholarships Do We Offer?
- 15** Tuition
- 16** Accommodation Information
- 17** Scientific Research
- 22** Honors and Awards
- 23** Campus Life
- 27** Residential Life



# MESSAGE FROM THE DIRECTOR

## Dear students,

Beijing Institute of Technology (BIT), founded in 1940, is one of China's leading national universities, consistently recognized under the prestigious "211 Project," "985 Project," and "Double First-Class" initiatives. BIT holds a prominent position in both domestic and global academic spheres, with its influence reflected in numerous accolades. These include a rank of 302 in the 2025 QS World University Rankings, a position within the 101-150 range in the 2024 Academic Ranking of World Universities (ARWU), 179th in the 2024 U.S. News & World Report Best Global Universities Rankings, 201-250 in the 2025 Times Higher Education World University Rankings (THE), and a commendable 9th place in the Chinese Mainland according to the QS Global Graduate Employability Rankings 2022. BIT also holds the top spot for Higher General Education Accreditation for International Students in China.

Beijing Institute of Technology is a place brimming with opportunities and challenges. As a leading research university in China, BIT offers world-class faculty, cutting-edge facilities, and a rich, dynamic learning environment. Our diverse and forward-thinking curriculum, combined with hands-on experiences, ensures you are engaged and well-prepared for the future. Through specialized courses, innovation training, and field studies, you will cultivate both your creative spirit and practical skills.

Cherish your time at BIT, nurture your dreams with commitment, and let your brilliance shine as you grow alongside us, writing a chapter of your youth filled with purpose and without regret. Beijing Institute of Technology warmly welcomes you!



**GAO Shan**

Director, Office of International Students  
Beijing Institute of Technology



# BIT RANKINGS

## In the WORLD

Academic Ranking of World Universities (ARWU) 2024 **Top 101-150**

U.S.News & World Report 2024-2025 Best Global Universities Rankings **Top 179**

Times Higher Education World University Rankings 2025 **Top 201-250**

QS World University Rankings 2025 **Top 302**

QS Employer-Student Connections Rankings 2022 **Top 7**

QS Partnerships with Employers World Rankings 2022 **Top 63**

QS World University Rankings 2025

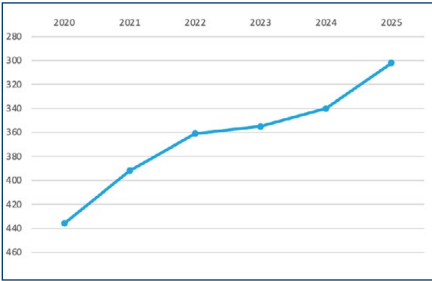

Academic Ranking of World Universities (ARWU) 2024

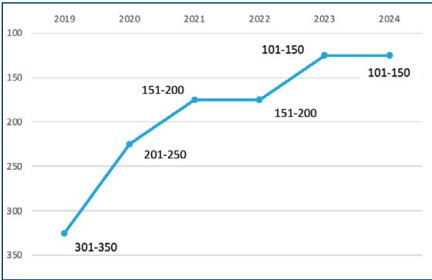

## In CHINA

Science and Engineering Field **Top 10**

QS Graduate Employability Rankings 2022 **Top 9**

QS Best Student Cities 2023: Beijing **Top 1** in Chinese mainland



# BIT FIGURES

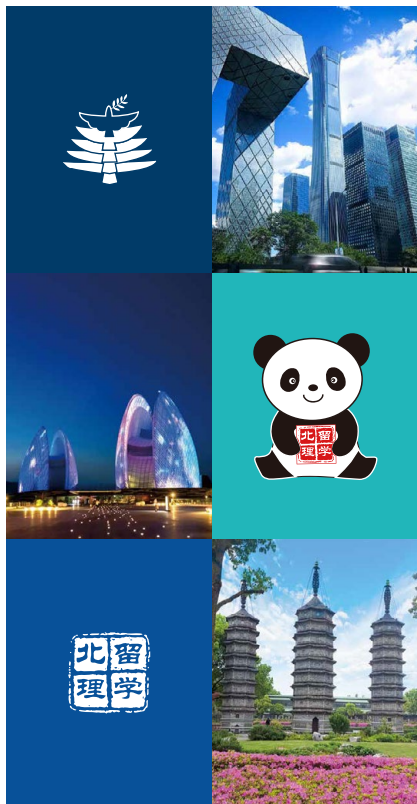

Full-time students **33,161**

Undergraduates **15,106**

Students in master's programs **11,737**

Students in Ph.D. programs **6,318**

International students **3,400+**

Faculty and staff **6,391**

Academicians of the Chinese Academy of Sciences and Chinese Academy of Engineering **42**

State Key Laboratory **27**

National experimental teaching center **7**

2022 Scientific research fundings CNY **7.029** billion

National quality courses **61**



## SCHOOLS

# BEIJING INSTITUTE OF TECHNOLOGY

- 
01. School of Aerospace Engineering
  02. School of Mechatronical Engineering
  03. School of Mechanical Engineering
  04. School of Optoelectronics
  05. School of Information and Electronics
  06. School of Integrated Circuits and Electronics
  07. School of Automation
  08. School of Computer Science and Technology
  09. School of Cyberspace Science and Technology
  10. School of Materials Science and Engineering
  11. School of Chemistry and Chemical Engineering
  12. School of Life Science
  13. School of Medical Technology
  14. School of Mathematics and Statistics
  15. School of Physics
  16. School of Management
  17. School of Economics
  18. School of Education
  19. School of Law
  20. School of Foreign Languages
  21. School of Design and Arts

# UNDERGRADUATE PROGRAMS IN CHINESE

| 招生大类               | 覆盖学院  | 专业方向   |
|--------------------|---|--|
| 宇航与机电类             | 宇航学院、机电学院                                   | 航空航天工程（中/英文）、机械电子工程（中/英文）  |
| 智能制造与智能车辆类         | 机械与车辆学院                                     | 机械工程（中/英文）、工业工程、车辆工程、能源与动力工程、智能制造工程  |
| 信息科学技术类            | 自动化学院、计算机学院<br>网络空间安全学院                     | 自动化（中/英文）、电气工程及其自动化、计算机科学与技术（中/英文）、<br>软件工程、人工智能、数据科学与大数据技术、网络空间安全         |
| 电子信息类              | 光电学院、信息与电子学院<br>集成电路与电子学院                   | 光电信息科学与工程、测控技术与仪器、电子信息工程、通信工程、<br>电子科学与技术（中/英文）                            |
| 理学与材料类             | 材料学院、化学与化工学院<br>医学技术学院、生命学院<br>数学与统计学院、物理学院 | 材料科学与工程、材料化学、化学、应用化学、化学工程与工艺、制药工程、<br>能源化学工程、生物医学工程、生物技术、数学与应用数学、统计学、应用物理学 |
| 社会科学类<br>（管理与经济方向） | 经济学院、管理学院                                   | 国际经济与贸易（含数字金融、数字贸易方向）（中/英文）、<br>工商管理（含数字创新管理方向）、会计学                        |
| 社会科学类<br>（人文社科方向）  | 教育学院、法学院<br>外国语学院                           | 社会工作、法学、英语、日语、德语、西班牙语  |
| 工业设计类              | 设计与艺术学院                                     | 工业设计   |
| 设计学类               | 设计与艺术学院                                     | 产品设计、视觉传达设计、环境设计   |



# BEIJING INSTITUTE OF AERONAUTICS

## UNDERGRADUATE PROGRAMS IN ENGLISH

### **Aeronautical and Astronautical Engineering**

Main Courses: Introduction to Flight Vehicle System, Fundamentals of Fluid Mechanics, Structural Analysis, Optimization Design Methods, Spacecraft Dynamics, Control System Analysis & Design, System Dynamics & Vibration, Flight Vehicle Guidance and Control, Introduction to Combustion Theory, Aerodynamics, Flight Vehicle Design, Autonomous Control of UAV and Jet Propulsion.

### **Computer Science and Technology**

Main Courses: Essential Courses, Discrete Mathematics, Data Structures and Algorithms, Object-oriented Programming Computation Theory and Algorithms, Numerical Analysis, Database Principles and Design, Principles of Computer Organization, Assembly Language Programming, Operating Systems, Compiler Principles and Design, Fundamentals of Software Engineering, Computer Architecture, Practice of Operating System Principles, Computer Networks, Interface Technique of Microcomputer, Software Engineering Comprehensive Practice, Practice of Networking Technology.

### **Mechanical Engineering**

Main Courses: Computer Courses, Engineering Mechanics, Fundamentals of Mechanical Design course in group, Fundamentals of Engineering Materials, Electrical and Electronic Technology, Testing Technology, Microcomputer Principle and Interface Technology, CNC Technology, Fluid Mechanics, Control Engineering, Mechanical Manufacturing Engineering, CAD/CAM Principle, Mechanical Manufacturing Equipment Design, etc.

### **Electronics Science and Technology**

Main Courses: Fundamentals of Circuits Analysis, Fundamentals of Analog Circuits, Signals and Systems, Fundamentals of Control Theory, Digital Signal Process, Random Signal Analysis, Electromagnetic Field Theory, Information Theory, Computer Theory and Application, Communication Circuits and System, Digital Communication Theory, Theoretical Physics, Semiconductor Physics, Hardware Description Language, Microelectronic Process, Microelectronic Device, Analog Integrated Circuits Analysis and Design, Digital Integrated Circuits Analysis and Design, Integrated Circuits CAD, MEMS.



# F TECHNOLOGY

## Automation

Main Courses: Fundamental of Electric Circuits, Electronics, Computer Programming Language, Principles of Microcomputer and Interface, Electrical Engineering Technique, Electrical Measurement Technology, Power Electronics, Electrical Machinery and Drives, Fundamentals of Control Theory, Control System of Electrical Machinery, Motion Control System, Energy and Power Conversion Technique, Intelligent Building, Factory Electricity Supply, Electrical Engineering Network and Communication Technology.

## Mechatronics Engineering

Main Courses: Fundamentals of Mechanical Engineering, Fundamentals of Mechanical Design, Fundamentals of Electric Circuits, Fundamentals of Digital Electronics, Fundamentals of Analog Electronics, Fundamentals of Mechatronic Control Engineering, Computer Control and Servo System, Introduction to Robotics.

## International Economics and Trade

Main Courses: Calculus, Econometrics, Financial Management, Fundamentals of Accounting, Human Resource Management, International Finance, International Marketing, Macroeconomics, Management Information Systems, Microcomputer Database Applications, Microeconomics, Monetary Banking, Operation Research, Principle of Management.

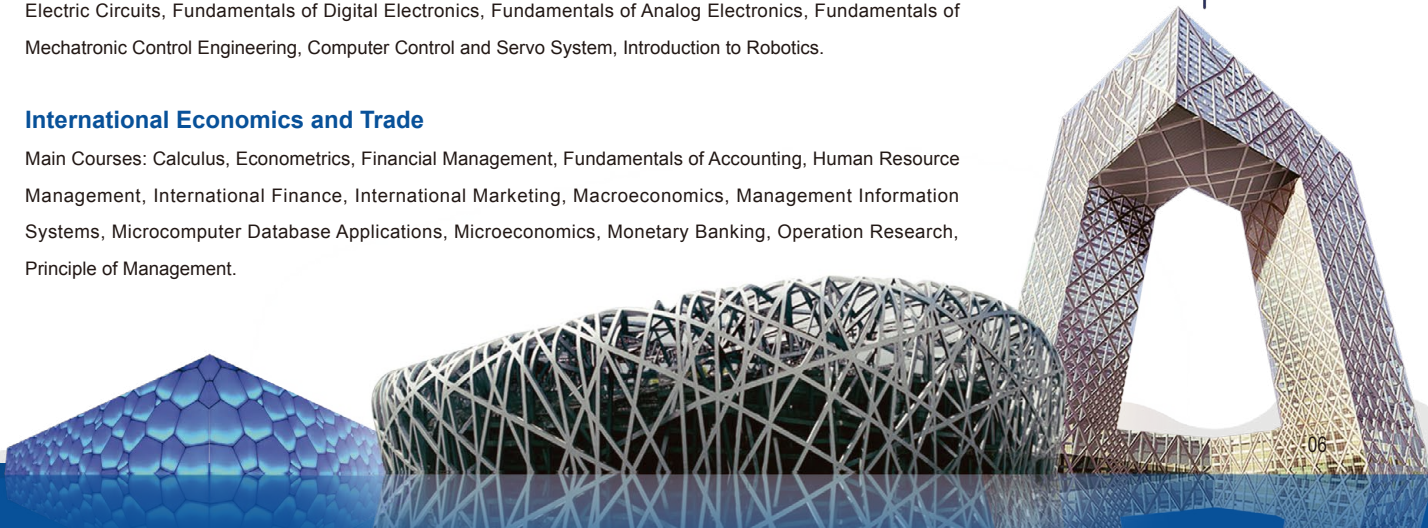

# MASTER'S PROGRAMS IN CHINESE AND ENGLISH

## Master's Programs

| Taught in Chinese/English  |   | Taught in Chinese   |
|--|---|---|
| <p><b>A</b>eronautics &amp; Astronautics Science &amp; Technology</p> <p><b>M</b>echanics</p> <p><b>A</b>rmament Science and Technology</p> <p><b>S</b>afety Science and Engineering</p> <p><b>M</b>echanical Engineering</p> <p><b>P</b>ower Engineering and Engineering</p> <p>Thermophysics</p> <p><b>O</b>ptical Engineering</p> <p><b>I</b>nstrument Science and Technology</p> <p><b>I</b>nformation and Communication Engineering</p> <p><b>E</b>lectronics Science and Technology</p> <p><b>I</b>ntegrated Circuit Science and Engineering</p> <p><b>C</b>ontrol Science and Engineering</p> | <p><b>C</b>omputer Science and Technology<br/>(Beijing/Zhuhai Campus)</p> <p><b>C</b>yberspace Science and Technology</p> <p><b>C</b>hemical Engineering and Technology</p> <p><b>C</b>hemistry</p> <p><b>B</b>iology</p> <p><b>B</b>iomedical Engineering</p> <p><b>P</b>hysics</p> <p><b>M</b>BA (Professional)</p> <p><b>M</b>aterial Science and Engineering (Zhuhai Campus)</p> <p><b>A</b>ppplied Economics</p> <p><b>L</b>aw</p> | <p><b>M</b>anagement Science and Engineering</p> <p><b>B</b>usiness Administration (Academic)</p> <p><b>M</b>aster of Engineering Management</p> <p><b>T</b>heoretical Economics</p> <p><b>N</b>ational Economy Mobilization</p> <p><b>M</b>athematics</p> <p><b>S</b>tatistics</p> <p><b>E</b>ducation</p> <p><b>I</b>nternational Chinese Language Education</p> <p><b>D</b>esign</p> |

# PH.D. PROGRAMS IN CHINESE & ENGLISH

**A**eronautics & Astronautics Science & Technology

**M**echanics

**A**rmament Science and Technology

**S**afety Science & Engineering

**M**echanical Engineering

**P**ower Engineering and Engineering Thermophysics

**O**ptical Engineering

**I**nstrument Science and Technology

**I**nformation and Communication Engineering

**E**lectronics Science and Technology

**I**ntegrated Circuit Science and Engineering

**C**ontrol Science and Engineering

**C**omputer Science and Technology (Beijing/Zhuhai Campus)

**C**yberspace Science and Technology

**M**aterials Science and Engineering (Beijing/Zhuhai Campus)

**C**hemical Engineering and Technology

**C**hemistry

**B**iology

**B**iomedical Engineering Mathematics

**S**tatistics

**P**hysics

**M**anagement Science and Engineering

**B**usiness Administration

**A**ppplied Economics

**N**ational Economy Mobilization

**E**ducation

**L**aw

**T**heoretical Economics



# NON-DEGREE PROGRAMS

## Long-term Chinese Programs (Beijing/Zhuhai Campus)

- 💎 3 Levels
- 💎 16 weeks each semester and 20 hours per week
- 💎 Semesters start in March or September each year
- 💎 Emphasis on communication skills
- 💎 Small group study
- 💎 Free HSK training
- 💎 Field trips: the Great Wall, the Forbidden City, the Summer Palace, etc.



## Exchange Programs

- 💎 1-2 semesters
- 💎 Chinese/English taught programs available
- 💎 Intensive Chinese language program available
- 💎 Free Chinese courses for beginners
- 💎 Final thesis / project with supervision from BIT professors available
- 💎 Various Chinese culture experiences



## Pre-university Programs (Zhuhai Campus)

- 💎 Reach the level of undergraduate admission in 1 or 2 semesters
- 💎 Courses: Comprehensive Chinese, Mathematics, Physics, Outline of China, Intercultural Communication and Team Management, Chinese Cultural Inheritance and Scientific Innovation, Activities, Speech and Application Guidance
- 💎 The priority to enter BIT undergraduate programs
- 💎 The priority to receive BIT Freshman Scholarship



## BIT Summer/Winter Programs

- 💎 Program A: Data Science, Big Data Technology, Intelligent Vehicles, Electric Vehicles, Electronics, etc.
- 💎 Program B: Chinese Language and Culture
- 💎 BIT Official electronic transcript with credits and certificate offered
- 💎 Excellent and experienced teachers
- 💎 Live-streaming broadcast teaching + video playbacks + data sharing + interactive communication





# HOW TO APPLY?

## ◆ Qualifications and Application Materials

| Undergraduate Programs |   | Graduate Programs   | Chinese Language Programs  |
|------------------------|---|---|--|
| Qualifications         | 1. High school graduates<br>2. Proficient in Chinese or English<br>3. Age from 18 to 25   | 1. Applicants for master's programs should have a bachelor's degree; applicants for Ph.D. programs should have a master's degree in the same major or in the relative field of interest.<br>2. Proficient in Chinese or English<br>3. Recommended by two professors / associate professors<br>Note: If you are applying for admission under Chinese Government Scholarship, please first apply online at CSC Online Application System. Please be known that the Agency Number of Beijing Institute of Technology is 10007. | 1. High school graduates<br>2. Above 18  |
|                        | Application Materials<br>1. Application form (Please register at <a href="http://apply.isc.bit.edu.cn">http://apply.isc.bit.edu.cn</a> ).<br>2. The Photocopy of Passport (photo page and valid China visa page if you are already in China);<br>3. Statement of Purpose & Study Plan & CV;<br>4. Notarized highest degree certificate (Chinese or English version);<br>5. Notarized transcripts of the highest degree (Chinese or English version);<br>6. HSK 5 (above 180) for Chinese-taught programs; English Language test result (TOEFL 85 or IELTS 6.0) for English-taught programs;<br>7. Two recommendation letters by professors or associate professors and Recommendation Form for International Student by BIT Advisors (only for Master's & Ph.D. applicants);<br>8. Physical Examination Record for Foreigner<br>Note: 1. Documents in language other than Chinese or English need to be translated into Chinese or English.<br>2. Native English speakers or graduates from high school with English as the official teaching language are exempt from TOEFL or IELTS.<br>3. CSC applicants please register at <a href="https://studyinchina.csc.edu.cn">https://studyinchina.csc.edu.cn</a> . Agency Number of Beijing Institute of Technology is 10007. |   |  |
| Deadline               | June 15 <sup>th</sup> , 2025  | February 15 <sup>th</sup> , 2025 (CSC applicant, Round 1)<br>April 15 <sup>th</sup> , 2025 (CSC applicant, Round 2)<br>June 15 <sup>th</sup> , 2025 (self-funded applicant)   | Spring semester: December 15 <sup>th</sup> , 2024<br>Fall semester: June 15 <sup>th</sup> , 2025 |

# WHAT SCHOLARSHIPS DO WE OFFER?

## 1. Chinese Government Scholarship (CSC)

### (1) University Program (Type B)

Including Silk Road Program, High-level Graduates Program, etc.

#### ♦ What does the CSC FULL scholarship cover?

- ① Tuition fees;
- ② Free university dormitory or accommodation subsidy;
- ③ Stipend:
  - Undergraduates: CNY 2,500/month
  - Master' s students / General scholars: CNY 3,000/month
  - Ph.D. students / Senior scholars: CNY 3,500/month
- ④ Comprehensive medical insurance: CNY 800/person/year; CNY 400/person (for programs lasting less than six months)



#### ♦ Who can apply?

To be eligible, an applicant must:

- ① be a citizen of a country other than the PRC and in good health both mentally and physically;
- ② be an academically excellent holder of high school diploma or its equivalent under the age of 25 when applying for an undergraduate program;
- ③ be an academically excellent holder of a bachelor' s degree or its equivalent under the age of 35 when applying for a master' s program;
- ④ be an academically excellent holder of a master' s degree or its equivalent under the age of 40 when applying for a Ph.D. program;
- ⑤ be a holder of a high school diploma (or higher) under the age of 45 when applying for a general scholar program;
- ⑥ be a master' s degree holder or an associate professor (or above) under the age of 50 when applying for a senior scholar program;
- ⑦ meet the admission requirements of the applied degree or non-degree program.

### ◆ How to apply for University Program?

- ① Register at <https://studyinchina.csc.edu.cn> and upload required documents. (BIT' s Agency No.: 10007; Type: B)
- ② Register at <http://apply.isc.bit.edu.cn> and upload required documents.

Application deadline: February 15<sup>th</sup>, 2025(Round 1, recommended), April 15<sup>th</sup>, 2025 (Round 2)

### (2) Bilateral Program (Type A)

The program accords with the cooperation and exchange agreements or consensus reached by the Chinese government and the governments and institutions of other nations. It is open to undergraduates, postgraduates, general and senior scholars.

Applicants shall file an application with the dispatching department of their home countries.

### (3) Designated Scholarship Programs

Including Great Wall Program, EU Program, AUN Program, PIF Program and WMO Program. These programs are set up in accordance with cooperation agreements between China and international organizations and institutions. Applicants shall file an application with the international organizations and institutions concerned.

### (4) Student Exchange Program

The program, launched in accordance with exchange and cooperation agreements between Chinese universities and foreign partners, is designed to support general and senior scholars for a training session of no more than 12 months. Applicants shall file an application with Chinese universities and their foreign partners.

## 2. Beijing Municipal Government Scholarship

### ◆ What does the scholarship cover?

Tuition (Full scholarship, Half scholarship, 1/4 scholarship) for one year

### ◆ Who can apply?

- ① Non-Chinese Citizens in good health;
- ② Undergraduate program students: New students or enrolled students according to their qualified previous year' s academic records;
- ③ Age from 18 to 25.

### ◆ How to apply?

Apply online at <http://apply.isc.bit.edu.cn>.

### ◆ Application deadline:

For new students: January 1st to June 15<sup>th</sup>, 2025

For students in year 2 to 4: June

### 3. Guangdong Government Outstanding International Student Scholarship

The Guangdong Government Outstanding International Student Scholarship is exclusively available to students applying for programs located at the Zhuhai Campus of Beijing Institute of Technology.

#### ♦ Scholarship Amount

Master student: CNY 20,000/person

Ph.D student: CNY 30,000/person

#### ♦ Application Procedure

1. Download "Guangdong Government Outstanding International Student Scholarship Application Form" from ; <https://isc.bit.edu.cn/resourcesoffices/resources/index.htm>
2. Register at <https://apply.isc.bit.edu.cn/> and upload required documents.

### 4. International Chinese Language Teachers Scholarship

#### ♦ What does the scholarship cover?

Tuition, accommodation, living allowance and medical insurance.

**Living allowance:** CNY 2,500/month (Language Students)  
CNY 3,000/month (Master's Students)

#### ♦ Who can apply?

1. Non-Chinese citizens;
  2. Should be friendly to China, have no criminal record, and abide by the laws and regulations of the Chinese government and the rules and regulations of the school;
  3. In good physical and mental conditions, and with a good record of academic performance and conduct;
  4. Aspiring to work in Chinese language education and related fields;
  5. Aged between 16 and 35 (as of September 1st, 2025), with the special allowance for the age limit of 45 for applicants currently working as Chinese language teachers.
- ① **Master's program:** The program starts from September each year and the duration of scholarship is 2 years. Applicants should have bachelor's degree and a minimum score of 210 in HSK Test (Level 5), and 60 in HSKK Test (Intermediate Level) for full scholarship. Applicants who have the contract (notarized) with the institute where they intend to work after graduation are preferred.
- ② **One-year study program:** The program starts from September every year and the duration of scholarship is



11 months. Applicants who have benefited from similar scholarships are not eligible and should have a minimum score of 270 in HSK Test (Level 3), and 60 in HSKK Test (Beginning Level).

- ③ **One-semester study program:** The program starts from September or March each year and the duration of scholarship is 5 months. Applicants holding the X1 or X2 visa are not eligible. Applicants should have a minimum score of 180 in HSK Test (Level 3), and HSKK test score is required.

#### ◆ How to apply?

Please visit <http://cis.chinese.cn/> and choose “Beijing Institute of Technology”. Fill in the application form and upload the required documents online.

Application Period: March 1st – May 15th every year (For details, please refer to the Application Information issued by Center for Language Education and Cooperation every year)  
For more information, please visit the official page of International Chinese Language Teachers Scholarship:  
<http://cis.chinese.cn>  
Official page of HSK Test: <http://www.chinesetest.cn>

## 5. BIT International Student Scholarship

### ◆ What does the scholarship cover?

Tuition fees

### ◆ Who can apply?

- ① Non-Chinese citizens and in good health both mentally and physically;
- ② Apply for undergraduate programs or dual-degree programs.

### ◆ How to apply?

Register at <http://apply.isc.bit.edu.cn>.

### ◆ Application deadline:

October 15<sup>th</sup>, 2024 - June 15<sup>th</sup>, 2025



# TUITION

| Undergraduate Programs  | Master's Programs   | Ph.D. Programs | Chinese Language Programs                  | Short-term Programs   |
|---|---|----------------|--|---|
| Programs in Chinese:<br>CNY 23,000/year   | Programs in Chinese:<br>CNY 32,000/year                         | CNY44,400/year | Language & Culture:<br>CNY 10,000/semester | Customized pricing<br>based on specific<br>project requirements |
| Programs in English:<br>CNY 30,000/year   | Programs in English:<br>CNY 36,000/year<br>MBA: CNY 49,000/year |                | Pre-university:<br>CNY 15,000/semester     |   |
| Note: Application fee: degree programs CNY 600   non-degree programs: CNY 500<br>Insurance: CNY 800/year   CNY 400/semester |   |                |  |   |



# ACCOMMODATION INFORMATION

| Campus                                   | Location  | Room types           | Facilities  | Price                      |
|--|---|----------------------|---|----------------------------|
| Zhong Guan Cun Campus<br>(Beijing)       | Building No. 14<br>(On-campus)                    | 2 people shared room | Air-conditioner, desk, chair, wardrobe, internet access, refrigerator, bathroom (24-hour hot water), public kitchen on each floor, public laundry | CNY 1350<br>/person/month  |
|  |   | 3 people shared room |   | CNY 1200<br>/person /month |
|  |   | 4 people shared room |   | CNY 900<br>/person /month  |
|  | Building No. 16<br>(On-campus)                    | 4 people shared room | Air-conditioner, desk, chair, wardrobe, internet access, bathroom (24-hour hot water)   | CNY 900<br>/person/month   |
| Liang Xiang Campus<br>(Beijing)          | Building No.1<br>(On-campus)                      | 2 people shared room | Air-conditioner, desk, chair, wardrobe, internet access, private bathroom, private kitchen, private refrigerator, public laundry (dryer included) | CNY 900<br>/person/month   |
|  |   | 3 people shared room |   | CNY 700<br>/person/month   |
|  |   | 4 people shared room |   | CNY 500<br>/person/month   |
|  | Building No.2<br>(Off-campus)                     | 2 people shared room | Air-conditioner, desk, chair, wardrobe, free internet, private bathroom, public laundry (dryer included)  | CNY 900<br>/person/month   |
|  |   | 4 people shared room |   | CNY 500<br>/person/month   |
|  |   |                      |   |                            |
| Zhuhai Campus<br>(Zhuhai,<br>Guangdong ) | International<br>Student Dormitory<br>(On-campus) | 2 people shared room | Air-conditioner, desk, wardrobe, internet access, private bath room, public laundry   | CNY 900<br>/person/month   |
|  |   | 3 people shared room |   | CNY 700<br>/person /month  |
|  |   | 4 people shared room |   | CNY 500<br>/person /month  |

# SCIENTIFIC RESEARCH

## DIGITAL MEDIA

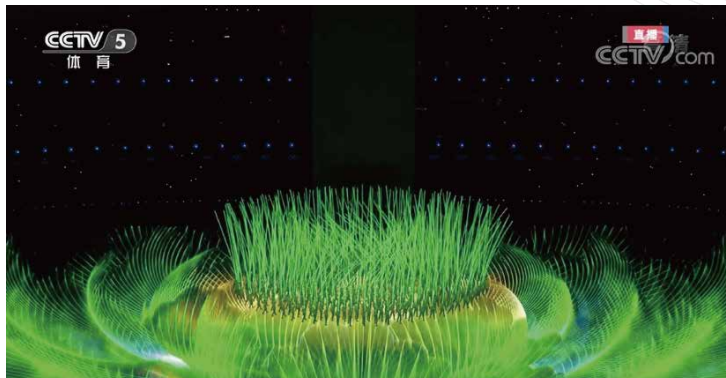

### Rehearsal Simulation Technology 仿真排演技术

The technology developed by BIT was used in the Spectacular “Beijing 8-Minute Show” at the Closing Ceremony of the 2018 Pyeongchang Winter Olympics, the parade on the 70th Anniversary of the Founding of the PRC, and the Opening Ceremony of the 2022 Beijing Winter Olympics.

北理工研发的该技术运用在了2018年平昌冬奥会闭幕式上壮观的“北京8分钟”秀，庆祝中华人民共和国成立70周年阅兵式和2022年北京冬奥会开幕式上。

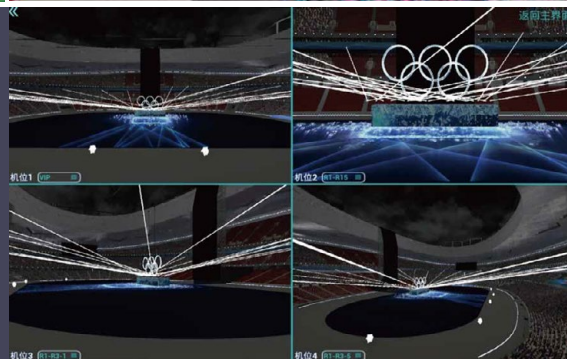

# SCIENTIFIC RESEARCH

## CHEMISTRY & CHEMICAL ENGINEERING



### Environmentally Friendly Fireworks

#### 环保烟花

The environmentally friendly fireworks are invented for the opening ceremonies of the 2008 Summer Olympics, the 2022 Winter Olympics, the 2010 World Expo, APEC in 2014, and the 80th anniversary of BIT in 2020. 北理工研发的环保烟花运用于2008年北京奥运会和2022年北京冬季奥运会，2010年世博会，2014年APEC的开幕式和2020年北京理工大学八十周年校庆上。



## SCIENTIFIC RESEARCH INTELLIGENT ROBOT

### HUITONG Robot “汇童” 仿真机器人

These humanoid robots can distinguish high-speed objects, make dynamic balance, play table tennis with each other; run and jump; and communicate with humans with facial expressions.

这些人形机器人可以分辨高速物体、保持动态平衡，从而打乒乓球；跑步和跳跃；有表情地与人类交流。

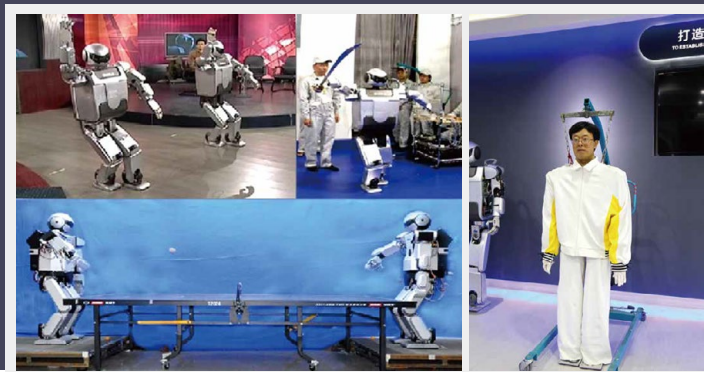

## AEROSPACE AND DEEP SPACE EXPLORATION



### BP-1B Satellite “北理工1号” 卫星

In 2019, this satellite was successfully launched at Jiuquan Satellite Launch Center in China.

2019年，“北理工1号”卫星在中国酒泉卫星发射中心成功发射。

### Microwave Radar Technology 微波雷达信号处理机

Microwave Radar Technology assisted in the rendezvous and docking of Spacecraft Shenzhou-VIII and Shenzhou-IX with Space Module Tiangong-I.

微波雷达信号处理机与微波应答机信号处理机助“神舟”系列与“天宫”交会对接。

BEIJING IN

# SCIENTIFIC RESEARCH

## MECHANICAL ENGINEERING



### EV under Extreme Cold Condition

“不怕冷的山地车”

These pure electric vehicles can operate normally under the ultra-wide ambient temperature of  $-40^{\circ}\text{C}$  to  $60^{\circ}\text{C}$ .

这些纯电动汽车可以在 $-40^{\circ}\text{C}$ 至 $60^{\circ}\text{C}$ 的超宽环境温度下正常运行。



### Formula Student Autonomous China

中国大学生无人驾驶方程式大赛

BIT team won the national championship in Formula Student Autonomous China in 2017, 2018, 2020, 2021, and 2022.

北理工团队在中国大学生无人驾驶方程式大赛上五次夺得全国总冠军。





## Indoor Multi-DOF Simulation Ski Training System

### 室内多自由度模拟滑雪训练系统

The system can provide indoor ski simulation training equipment for athletes in alpine skiing, cross-country skiing, and other events to improve the training efficiency of their special technical movements such as slewing and sliding, and provide simulated training for athletes in non-snow seasons.

这个训练系统可以为高山滑雪、越野滑雪等项目的运动员提供室内滑雪模拟训练设备，提高其回转、滑行等特殊技术动作的训练效率，并在非雪季为运动员提供模拟训练。

## SCIENTIFIC RESEARCH



### Ice Cannon 人体高速弹射装置

The Ice Cannon assists speed skaters to carry out the technical training of curve skating, which can realize the precise control of the athletes' acceleration process.

人体高速弹射装置辅助速滑运动员进行曲线滑行的技术训练，从而实现对运动员加速过程的精确控制。

## INTELLIGENT SPORTS TRAINING



### Sports Data Steward 运动数据管家

The system can conduct real-time scientific analysis on the spot to help coaches and athletes find deficiencies more accurately and improve performance through targeted training.

运动数据管家系统可以在现场进行实时科学分析，帮助教练员和运动员更准确地找到不足之处，并通过有针对性的训练提高成绩。

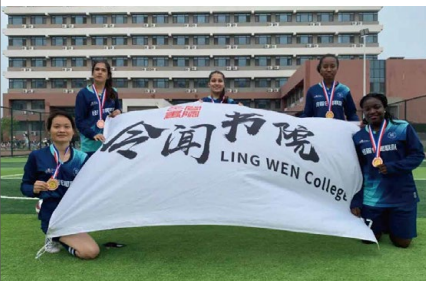

## HONORS AND AWARDS WONDERFUL CAMPUS LIFE



2021 "100 reasons to love Beijing" theme collection activity  
2021 The Second Global Cross border E-commerce Entrepreneurship and Innovation Competition  
2021 Telling Chinese Stories in English  
2021 Youth Art Works Competition on the 30th Anniversary of China ASEAN Dialogue Relations  
2021 Silk Road Youth Gathering Photography Competition  
2022 "CATTI Cup" National Translation Competition  
2022 "Youth Innovation Beijing" Youth Series Four Seas Race Track

First prize  
Outstanding Organization Award

First Prize  
Gold Medal

Most Popular Award  
First Prize  
Silver Medal

2022 "Experience China's New Era" Essay, Photography and Short Video Competition  
2023 Global Branding Competition (Singapore)  
2023 Telling Chinese Stories in English  
2023 "CATTI Cup" National Translation Competition  
2023 The 11th Beijing University Student Calligraphy Competition  
2023 The 7th Wushu Competition for International Students in Capital Universities  
2024 Youth Creations on Shared Prosperity Contest  
2024 "Foreign Cultural Trade" Talents Selection Competition for International Youth  
2024 Telling Chinese Stories in English

First Prize  
Silver Award  
Grand Prize  
First Prize  
First Prize  
First Prize  
Second Prize  
Cultural Mutual Learning and Friendship Award  
Good Storyteller



# Beijing Campus



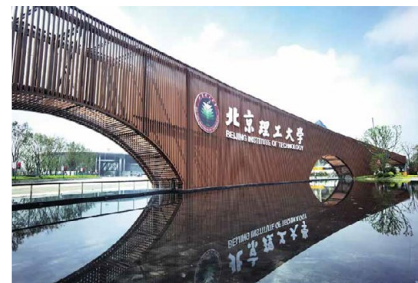
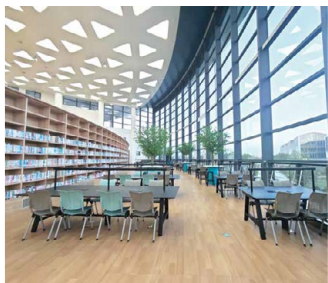
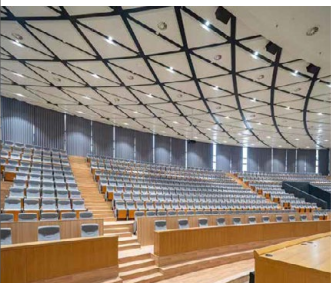



# Zhuhai Campus

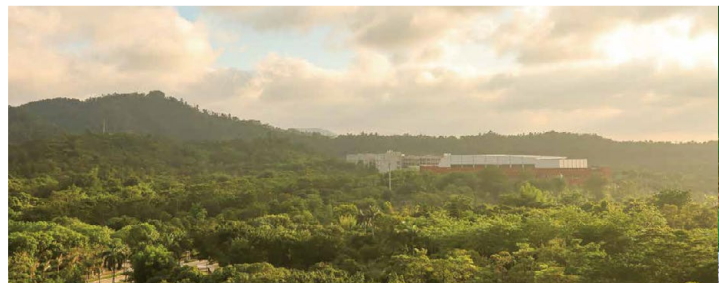
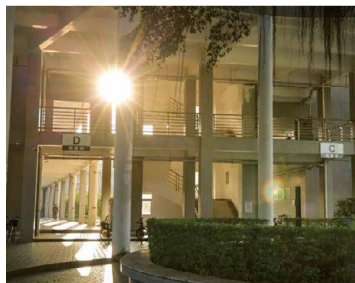
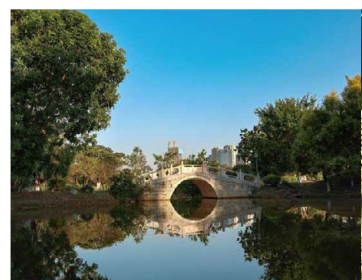







# RESIDENTIAL LIFE

## Beijing Campus



# RESIDENTIAL LIFE

## Jiaxing Campus





# RESIDENTIAL LIFE

## Zhuhai Campus



# Jiaxing Campus



## Office of International Students Beijing Institute of Technology

5 South Zhong Guan Cun Street, Hai Dian District, 100081, Beijing, P.R. China.

Tel: +86-10-68918272

Fax: +86-10-68914846

Website: <http://isc.bit.edu.cn>

<http://www.bit.edu.cn>

Facebook: @StudyInBIT



StudyInBIT

**STUDY IN  
BIT**

